

# RESIDENTIAL FENCE REQUIREMENTS

**PERMIT NOT REQUIRED:** Building permits are not required for the construction of fences which are 6 feet in height or less.

## Good Neighbor Policy



Residents of Burnsville who wish to install a fence are urged to relay their intentions to their abutting neighbors and agree on exact property line locations. With wood fences, it is suggested that they be located so that both sides of the fence can be maintained without leaving your property. Also, fences with one finished side should be located towards your neighbors.

**LOCATIONS:** Fences shall be located entirely upon the private property of the persons constructing the fence unless the owner of the property adjoining agrees, in writing, that such fence may be erected on the division line of the respective properties. The City may require the owner of property with an existing fence to establish the boundary lines of his property by a survey. **The owner of the property is responsible for verifying their property lines.**

**TRAFFIC VISIBILITY:** No fences, shall be permitted to exceed thirty inches (30") in height within any front or side yard areas on a corner lot which may interfere with the visibility across the corner. A minimum sight triangle shall be established on each corner lot at every street intersection through which motorists shall have reasonable unobstructed view. The adjacent sides shall be located along the curb line or along the gutter line of streets without curb and gutter, and shall be fifty feet (50') in length. The third side shall be a straight line joining the end points of the adjacent sides. The City may order removal of vision obstructions located within the minimum sight triangle.

**CONSTRUCTION AND MAINTENANCE:** Fences shall be constructed in a workmanlike manner and of substantial material reasonably suited for its intended purpose. Every fence shall be maintained on both sides in a condition of good repair and shall not be allowed to become or remain in a condition of disrepair or danger, or constitute a nuisance, public or private. Any such fence which is, or has become dangerous to the City health or welfare, is a public nuisance, and the City may commence proper proceedings for the abatement thereof. Electrical fences shall not be permitted. Barbed wire fences shall only be permitted on farms or for special security requirements by conditional use permit.

## SPECIAL PURPOSE FENCES



Fences for special purpose and fences differing in construction, height or length may be permitted in any district by conditional use permit. Findings shall be made that the fence is necessary to protect, better or improve the premises.



100 Civic Center Parkway  
Burnsville, MN 55337-3817

Phone: (952) 895-4444  
Fax: (952) 895-4437

## Residential Fences

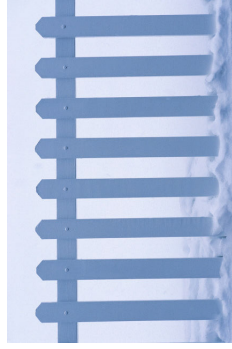

**"Listen Respectfully, Think Ahead, Act Responsibly"**

# RESIDENTIAL FENCE REQUIREMENTS

## CALL BEFORE YOU DIG;

### IT'S THE LAW!!

Minnesota State law requires that anyone digging in the vicinity of buried underground utilities call Gopher State One Call and have them located. You must call at least 48 hours before you plan to dig. **(651) 454-0002** You are responsible for locating all private, underground utilities. A private locating service list is available at [www.Gopherstateonecall.org](http://www.Gopherstateonecall.org)



## HEIGHT LIMITATIONS

Except as provided herein, fences outside the buildable area of a lot may not exceed six feet (6') in height.

Except as provided herein, fences within the buildable area of a lot or in the case of the rear lot line at least ten feet (10') from the rear lot line, may not exceed eight feet (8') in height. Fences over 6' in height require a building permit.

Fences extending across front yards shall not exceed three and one-half feet (3 1/2') in height and shall be at least seventy five percent (75%) open space for passage of air and light.

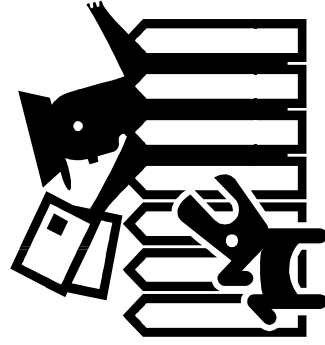

## SWIMMING POOL PROTECTION

All swimming pools for which a permit is required and granted shall be provided with safeguards to prevent children from gaining uncontrolled access. This can be accomplished with fencing, screening or other enclosure, or any combination thereof, of sufficient density as to be impenetrable. If fences are employed, they shall be at least four feet (4') in height. The bottoms of the fences shall not be more than four inches from the ground. Fences shall be of a noncorrosive material and shall be constructed so as to be not easily climbable. All fence openings or points of entry into the pool enclosure shall be equipped with gates or doors. All gates or doors to swimming pools shall be equipped with self-closing and self-latching devices placed at a sufficient height so as to be inaccessible to small children.

*"Listen Respectfully, Think Ahead, Act Responsibly"*

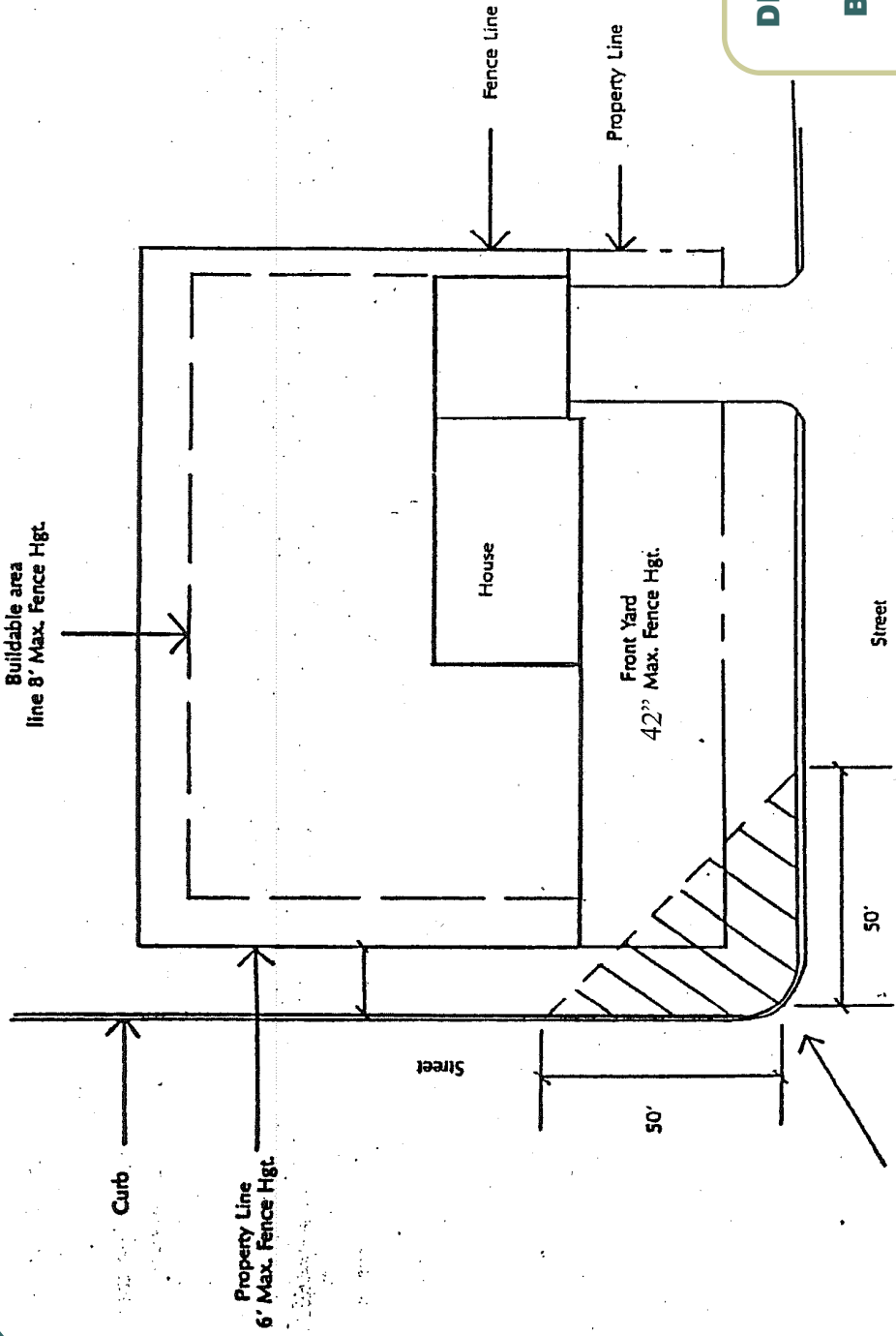

**DIAGRAM OF FENCE HEIGHTS AND BUILDABLE AREAS**

Nothing exceeding 30" in height allowed this area

*"Listen Respectfully, Think Ahead, Act Responsibly"*